

**TOSHIBA**

**Satellite®**

**200CDS - PA1234U**

Parts Information

# Satellite 200CDS

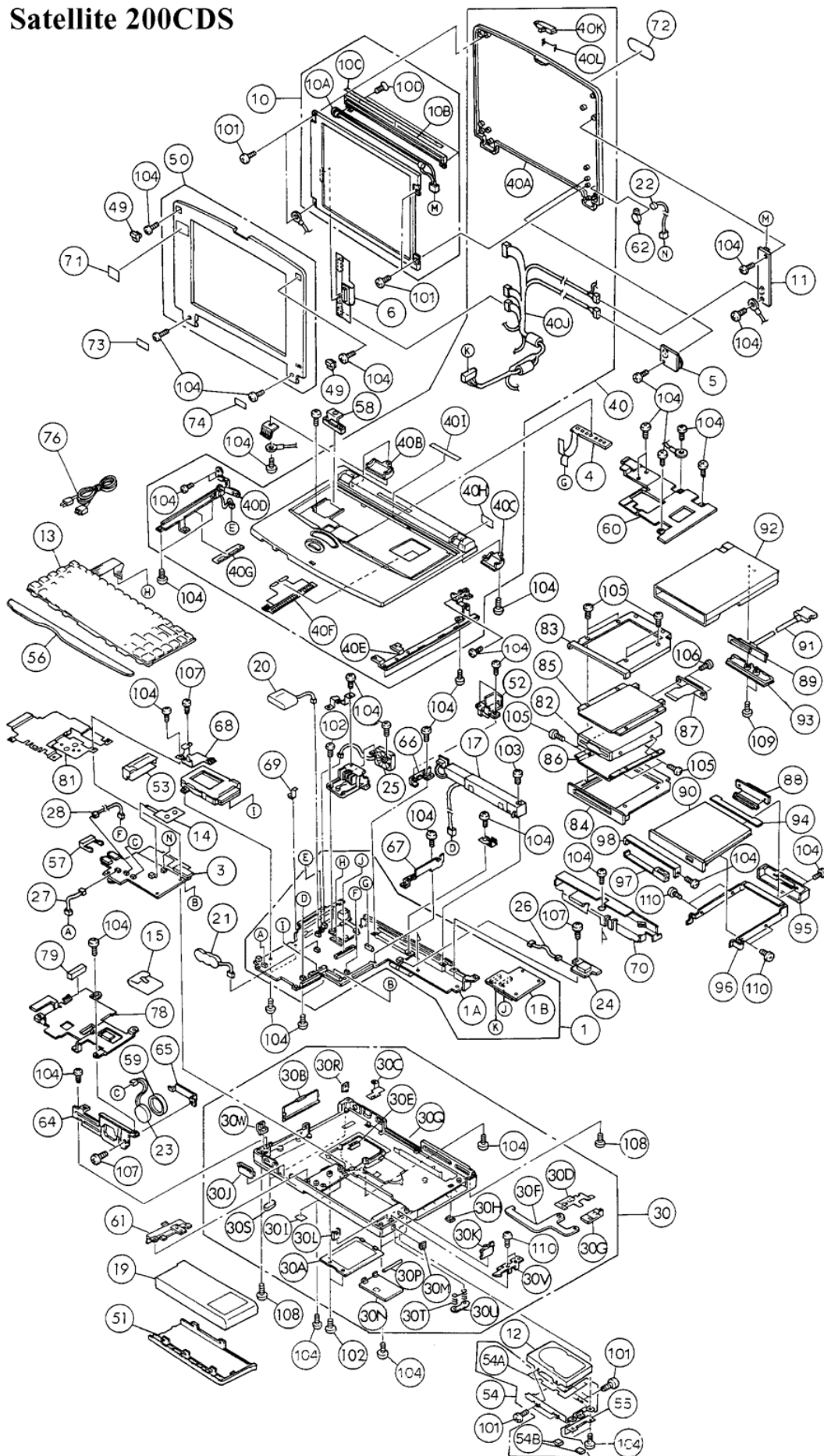

	<b>Toshiba PN</b>	<b>Description</b>
1A	P000223810	PCB F4NSY1
1B	P000223820	PCB F4NVD1
3	P000218460	PCB FV4SD2
4	P000205780	PCB FV2LE1
5	P000201660	PCB FHVVR1
6	P000211030	PCB FV3LS2
10	P000218730	COLOR LCD MODULE
10A	P000218740	FL TUBE
10B	P000218750	LAMP COVER
10C	P000221750	PET TAPE
10D	P000180700	SCREW M2X3.4
11	P000201740	FL INVERTER
12	P000205810	HDD UNIT (810MB)
1-12	P000221860	HDD UNIT (810MB)
2-12	P000223180	HDD UNIT (810MB)
3-12	P001024	HDD UNIT (4.3GB)
4-12	P001224	HDD UNIT (6GB)
5-12	P001424	HDD UNIT (10GB)
6-12	P001624	HDD UNIT (20GB)
13	P000203100	KEYBOARD UNIT
13-A	UE0283P05KB-SP	KEYBOARD UNIT, SPANISH
14	P000204650	MEMBRANE SWITCH
15	P000203220	STICK CAP SET
17	P000214570	AC POWER SUPPLY UNIT
19	PA2439UR	MAIN BATTERY (2800mAh)
20	P000201750	NI-MH BATTERY
21	P000205900	NI-MH BATTERY
22	P000205910	MICROPHONE
23	P000205920	SPEAKER
24	P000211680	INFRARED COM.
25	P000219870	25-10 DCFAN
26	P000216250	INNER HARNESS
27	P000205950	INNER HARNESS
28	P000218810	CD-ROM HARNESS
30	P000223770	BASE ASSEMBLY
30A	P000206190	MEMORY COVER ASSEMBLY
30B	P000206200	DSUB COVER
30C	P000206210	P/R SPRING, LEFT
30D	P000206220	P/R SPRING, RIGHT
30E	P000206230	MEMORY COVER SPRING
30F	P000206240	CD-ROM LOCK ARM
30G	P000206250	CD-ROM LOCK
30H	P000206260	CD-ROM LATCH KNOB
30I	P000206270	BATTERY SAFETY SPRING
30I-1	P000241400	BATTERY SAFETY SPRING
30I-2	P000279030	BATTERY SAFETY SPRING
30J	P000206280	SPEAKER NET
30K	P000211350	BATTERY LOCK
30L	P000206300	BATTERY LATCH
30M	P000206310	BATTERY LATCH KNOB
30N	P000206320	CD-ROM EJECT LEVER
30P	P000206330	SHAFT EJECT LEVER
30Q	P000218500	INSULATOR SHAFT
30R	P000202290	KEY HOLDER
30S	P000198350	BOTTOM CUSHION
30T	P000206350	POP-UP SPRING
30U	P000206360	BATTERY SPRING CAP
30V	P000215120	BATTERY LOCK SPRING
30W	P000214670	SWITCH BUTTON
40	P000218760	COVER ASSEMBLY
40-1	P000236050	COVER ASSEMBLY
N/S	P000237890	SPRING, EARTH
N/S	P000237800	LCD COVER ASSEMBLY
40A	P000218770	LCD COVER
40A-1	P000237340	LCD COVER
N/S	P000229090	COPPER TAPE
40B	P000214680	HINGE COVER, LEFT
40C	P000206410	HINGE COVER, RIGHT
40D	P000211380	SENSOR HARNESS ASSEMBLY

40D-1	P000237360	SENSOR HARNESS ASSEMBLY
40E	P000211390	BRAKE HINGE, RIGHT
40F	P000220020	KB SUPPORT EARTH
40G	P000220030	KB EARTH SPRING
40H	P000206460	LENS COVER
40I	P000206470	LED ICON SEAL
40J	P000218780	LCD HARNESS
40K	P000211410	LCD LATCH
40K-1	P000237350	LCD LATCH
40L	P000206500	LCD LATCH SPRING
49	P000211430	LCD CUSHION
50	P000218540	LCD MASK ASSEMBLY
51	P000211440	BATTERY COVER ASSEMBLY
52	P000211880	INSULATOR HOLDER ASSEMBLY
53	P000211800	SHUTTER ASSEMBLY
54	P000218930	HDD BRACKET ASSEMBLY
54-1	P000223670	HDD BRACKET ASSEMBLY
54A	P000222040	INSULATOR HDD BRACKET
54A-1	P000223680	INSULATOR HDD BRACKET
54B	P000221730	GUM CUSHION
55	P000218940	HDD HOLD BRACKET
56	P000211900	KB HOLDER
57	P000221970	AUDIO JACK COVER
58	P000225850	KB CONNECTOR COVER
59	P000206520	SPEAKER HOLDER
60	P000211450	HEAT SINK UPPER
61	P000225880	BATTERY CONNECTOR HOLDER
62	P000203600	MIC HOLDER
64	P000211910	SPEAKER BRACKET ASSEMBLY
65	P000206060	SPEAKER HOLDER
66	P000206070	VGA SUPPORT
67	P000221070	PACK CONNECTOR HOLDER
68	P000206090	EARTH CD-ROM
69	P000206100	RESET SWITCH SPRING
70	P000211930	PACK GUIDE ASSEMBLY
71	P000223830	PC NAME SEAL
71-1	NP200CDS	PC NAME SEAL
71-2	NP205CDS	PC NAME SEAL
72	P000223840	PC NAME SEAL(C)
72-1	8715	PC NAME SEAL(C)
73	P000206140	LCD MASK SEAL
74	P000206150	LCD MASK SEAL
76	P000202870	AC CORD SET
78	P000211480	SOUND SHIELD ASSEMBLY
79	P000214980	HEAT SINK
81	P000211940	SOUND SHIELD UPPER ASSY
82	P000219960	FDD 3.5INCH
83	P000207750	FDD COVER
84	P000207760	FDD BASE
85	P000209660	FDD SHIELD COVER
N/S	P000236320	TEAC FDD SHIELD-B
86	P000207780	FDD SHIELD BASE
87	P000205750	PCB FSTFD2
82-1	P000226830	FDD 3.5INCH
N/S	P000236310	FDD TOP COVER ASSEMBLY
82-1-1	P000236110	FDD 3.5 INCH
83-1	P000227720	FDD COVER
84-1	P000227730	FDD BASE
85-1	P000227740	FDD SHIELD COVER
85-1-1	P000227790	FDD SHIELD COVER
N/S	P000236300	TEAC FDD SHIELD ASSEMBLY
86-1	P000227750	FDD SHIELD BASE
87-1	P000227760	PCB FV5FD1
105-A	P000227770	SCREW M2.5X2.6B

105-B	P000169570	SCREW M2X6
82-2	P000226820	FDD 3.5INCH
83-2	P000227780	FDD COVER
84-2	P000227730	FDD BASE
85-2	P000227790	FDD SHIELD COVER
86-2	P000227800	FDD SHIELD BASE
86-2-1	P000230170	FDD SHIELD BASE
87-2	P000227810	PCB FV5FD2
N/S	P000228130	FDD GROUND PLATE
105-A	P000227770	SCREW M2.5X2.6B
105-B	P000169570	SCREW M2X6
88	P000216280	PCB FSTCD4
89	P000205800	PCB FV2FD2
90	P000217140	CD-ROM DRIVE
91	P000206170	FDD CABLE
92	P000207830	ADAPTER SUB ASSEMBLY
93	P000207840	REAR COVER
94	P000216780	CD-ROM PACK INNER
95	P000216790	CD-ROM PACK OUTER
96	P000216800	CD-ROM PACK PLATE
97	P000216760	BEZEL LOWER
98	P000223190	BEZEL UPPER
101	P000163450	SCREW M3X4
102	P000171940	SCREW M2X4
103	P000211500	SCREW M2.5X10Z
104	P000211490	SCREW M2.5X6Z
105	P000180260	SCREW M2X3B
106	P000169570	SCREW M2X6
107	P000209920	SCREW M2.5X4Z
108	P000160810	SCREW M2.5X8
109	P000161030	SCREW M2.5X6
110	P000210110	SCREW M2X3Z
<b>OPTIONS</b>		
OP	PA2031U	MEMORY KIT 8MB
OP	NW2031U	NW, 8MB MEMORY MODULE
OP	NW2031UX	NW, 8MB MEMORY MODULE
OP	KTT610/8	KINGSTON, 8MB MEMORY
OP	PA2032U	MEMORY KIT 16MB
OP	NW2032U	NW, 16MB MEMORY MODULE
OP	NW2032UX	NW, 16MB MEMORY MODULE
OP	KTT610/16	KINGSTON, 16MB MEMORY
OP	PA2034U	MEMORY KIT 32MB
OP	NW2034U	NW, 32MB MEMORY MODULE
OP	NW2034UX	NW, 32MB MEMORY MODULE
OP	KTT610/32	KINGSTON, 32MB MEMORY